

FOR STEEL HANDLEBARS

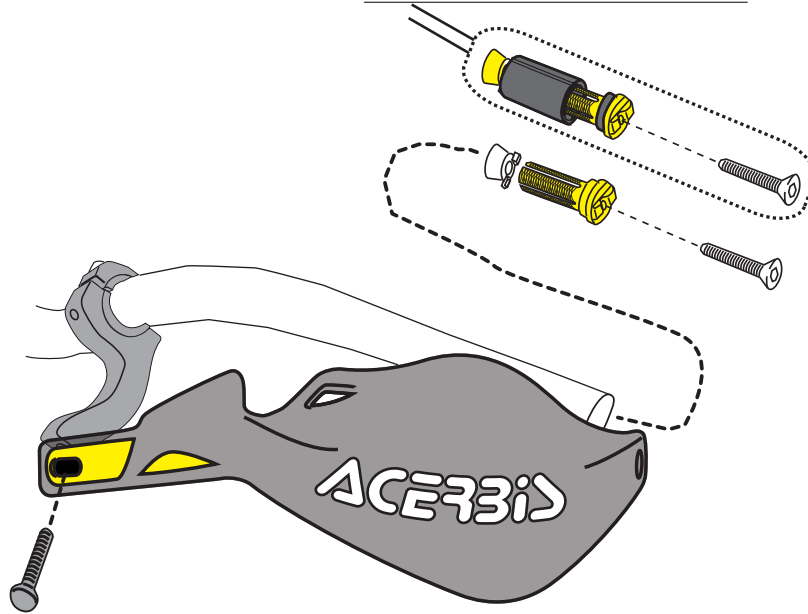

**for HANDLEBARS
28 mm
1.102 Inch**

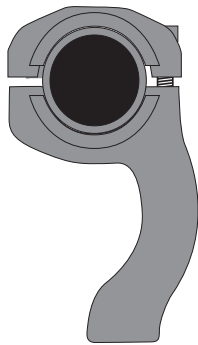

A - (2 pcs.)



B - (2 pcs.)



C - (4 pcs.)

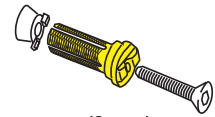

F - (2 pcs.)

**for HANDLEBARS
Ø 22 mm
Ø 0.866 Inch**

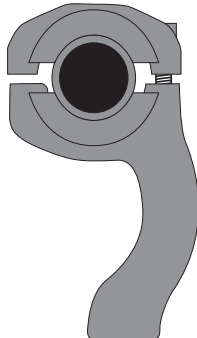

D - (4 pcs.)



E - (4 pcs.)

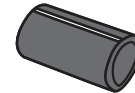

H - (2 pcs.)



I - (2 pcs.)

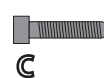

C

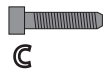

C

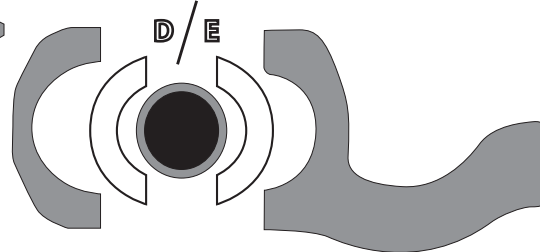

WARNING!

Follow mounting instruction exactly. Ensure that the mounting is secure before riding. These handguards will not prevent injury in the event of a crash. They are designed to protect the hands from cold weather and impact with small branches you might hit and flying debris. Be sure that you follow the instruction for installing the handguards. Do not ride with a broken tie wrap. Check to be sure the throttle and other controls are free every time you ride. Failure to heed instruction and this warning could lead to interference with the controls, loss of control of the motorcycle, and an accident.